



BINGFA STEEL STRUCTURE CO.,LTD.



BINGFA STEEL STRUCTURE CO., LTD

Address: No. 21-5, Block A, Southwest Garden, Nanfeng Avenue,
Sanshui District, Foshan City, Guangdong Province.
Tel: 0086-180 2419 4484 0086-180 2276 7786
Email: info@bingfasteelstructure.com
Http: //www.fsbingfa.com



Always provide you **A HOME**

Contents

3-4	Workshop Views
5-9	Steel Structure
10-11	K House
12-13	T House
14-15	Light Steel Structure Villa
16-17	Quick Container Assembly
18	Sandwich Panel
19	Quality Control&Package
20	BINGFA Service
21	Engineering Project Exhibition

BINGFA founded in 2008, located in Sanshui, Foshan, Guangdong China. is a factory with 30,000m² area and have production capacity :
 Steel structure: 6,000 T/year
 Prefab House: 300,000 m²/year
 Portable House: 6,000 units/year
 Sandwich Panel : 1,500,000 m²/year

We always enhance our application abilities of prefab house and promote the new-green type house under the work of our strong technical team, strict QC team, talent R&D team, rich experienced Sales Team, skilled Production Team. Basing on their good management, strict quality control and excellent service, we success to export our products to Australia, Middle East, Asia, Africa, South America etc. 35 countries

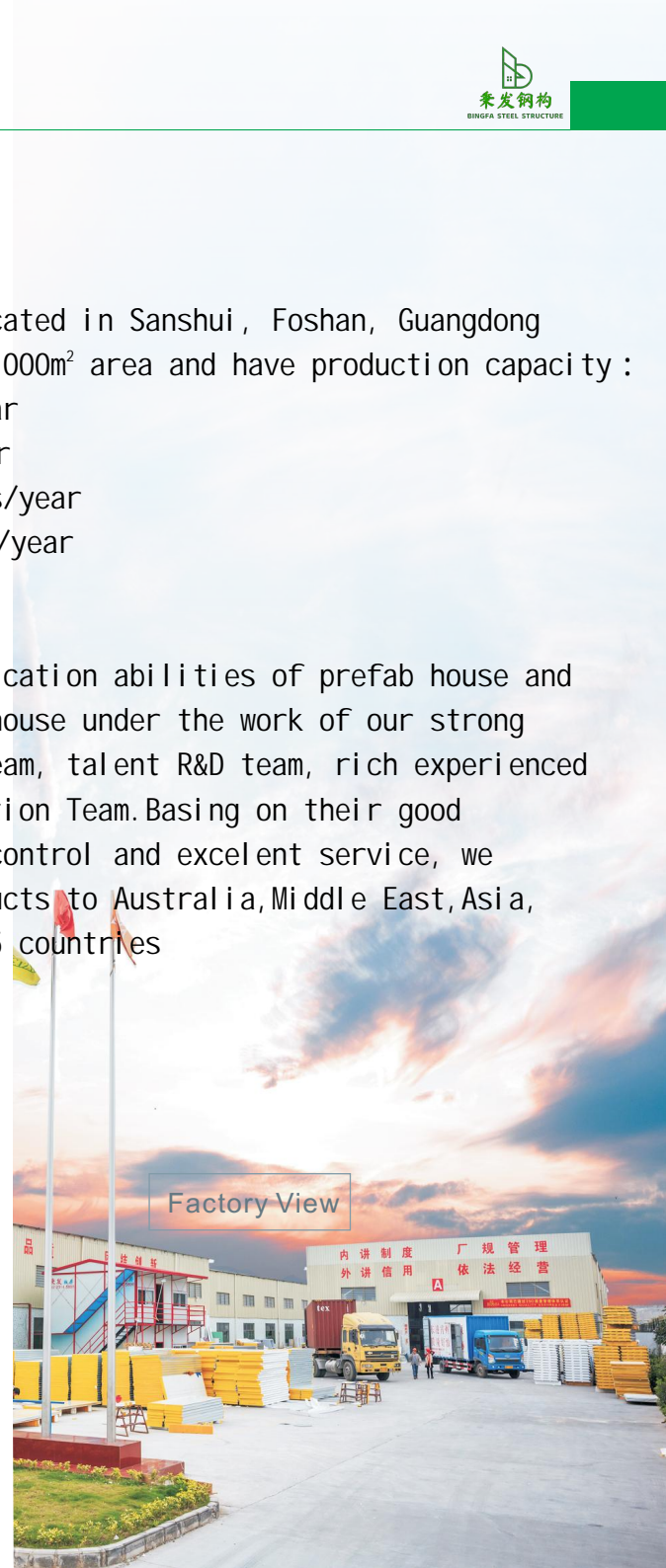

BINGFA WORKSHOP



Sandwich panel workshop



Sandwich panel workshop



Steel structure workshop



Steel structure workshop



Fittings production workshop



Fittings production workshop



Steel finished products workshop



Finished sandwich panel storage workshop

Five workshops with Three sandwich panel production line. Two steel structure production workshop, One painting room and One fittings production workshop, can satisfy their requirements of quality prefab products and timely delivery. In BINGFA, 80% of staffs are skillful and most of them have more than 10 years of experience in Prefab Building Filed, especially the welder, painter, sandwich panel machinery operator.



COMPANY CERTIFICATION



Genuine Manufacturer



ISO Certification



MGO Sandwich panel fireproof certification



Rock Wool Sandwich panel fireproof certification



Fire proof and environmental material



USA Steel Structure Inspection and Certification

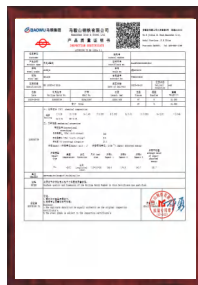

EU Steel Structure Inspection and Certification

BINGFA GROUP



It is our mission to let the world know prefabricate house. We will never stop to be better.

We are always for your strategy partner and reach win-win partnership



Always provide you **A HOME**

STEEL STRUCTURE BUILDING

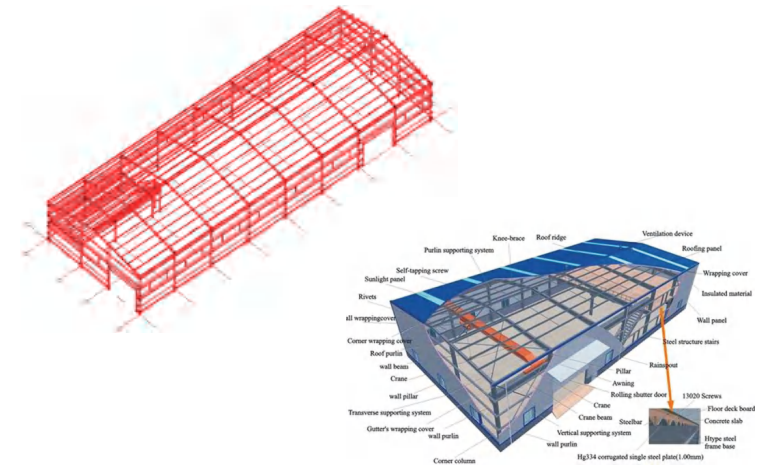
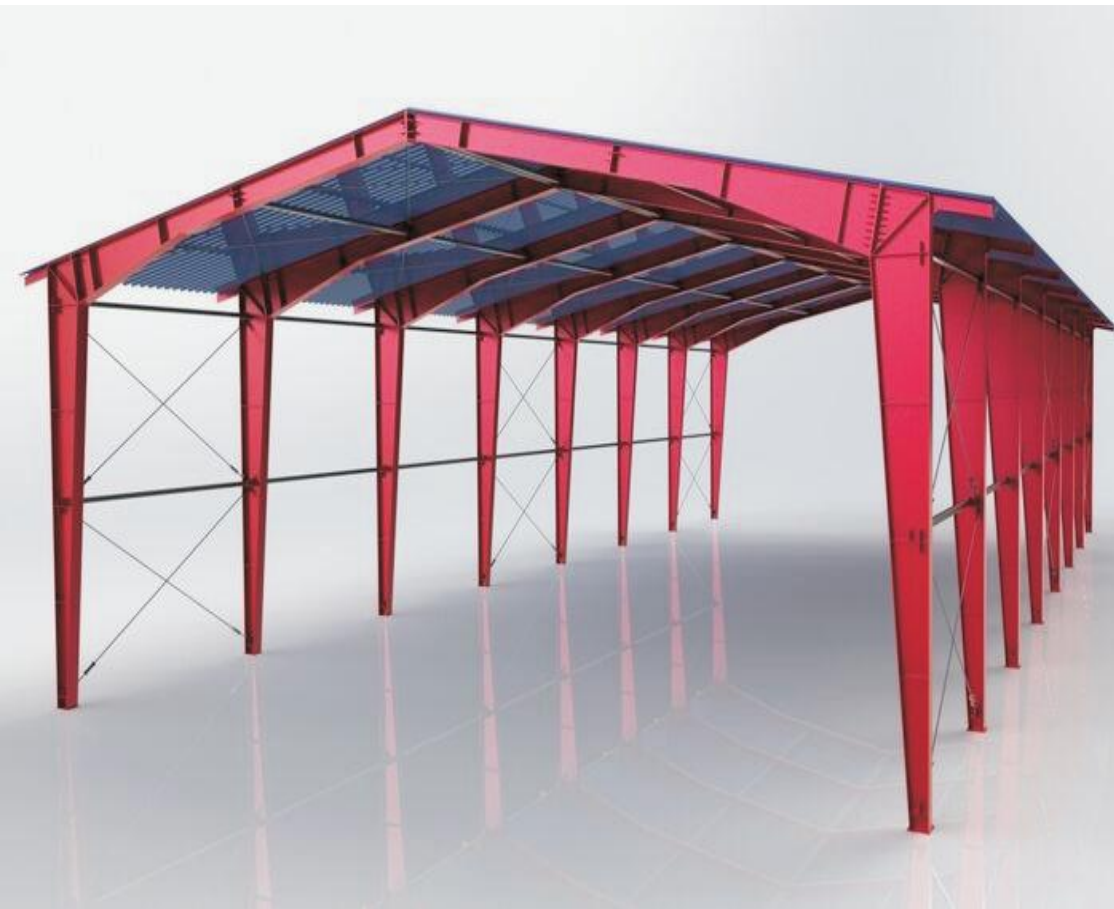

Steel structure building is a new type of building structuresystem. The main steel frame is formed by linking up H-Section, Z-Section and U-Section Steel components while roof and wall using a variety of panels.

Component	Speci fi cation
Main frame	Hot-dip galvanized or painted steel "H" steel, "C" and "Z" cold-formed thin-walled section steel, Q235
Roof	50mm-150mm EPS/PU/Rockwool sandwich panel / color steel roof sheet / glazed roof tile
Wall	50mm-150mm EPS, PU Rock wool sandwich panel.
Door	Sandwich panel door, security door or electric roller shutter door
Window	PVC sliding, aluminum alloy or shutter

Advantages:

1. Process a wide span, with either a single or multiple span and can have a maximum span clearance distance in 20m without middle columns.
2. Low Cost with unit price
3. Full bolt connection, fast assemble
4. Lifespan: 50 years
5. Structure stable, Earthquake resistance, waterproof, and energy saving

PROJECT OVERVIEW

STEEL STRUCTURE Paint Production Base

Steel structure paint production base enclosure and roof system adopts the following professional structural solutions:

Roof Structure: A full steel structure system is employed, which meets the operational requirements of industrial buildings for long spans and high load-bearing capacity.

Wall Construction: A composite enclosure system combining concrete and steel structure is adopted, balancing structural stability and enclosure durability.

Daylighting & Ventilation System: The side walls are equipped with a combination of aluminum alloy fixed windows and sliding windows, enabling a rational ratio of natural daylighting and ventilation.

Access & Emergency Systems: 4 industrial rolling shutter doors are installed to accommodate cargo access needs; the roof is equipped with electric smoke-discharge skylights, which serve both daily ventilation and emergency smoke evacuation functions, complying with fire safety codes for industrial buildings.



Industry: Paint production base

Place: Indonesia

Dimensions: 92x58x12m

Square Footage: 5336sqm

Column/Beam: H steel

Wall purlin: C purlin

Roof purlin: C purlin

Brace structure: Tie rod, tube, angle steel

Roof panel: Prepainted galvanized corrugated steel sheet

Door: Steel roller door



PROJECT OVERVIEW

STEEL STRUCTURE WAREHOUSE

Steel structure warehouses features of high fire resistance, strong corrosion resistance. Steel structure warehouses is mainly refers to the main bearing component is composed of steel. Including the steel columns, steel beam, steel structure, steel roof truss. Each component using welds, bolts or rivets to connect.



Industry: Store goods

Place: Philippines

Dimensions: 92'x160'x20'

Square Footage: 14,720 ft²

Column/Beam: H steel

Wall purlin: C purlin

Roof purlin: C purlin

Brace structure: Tie rod, tube, angel steel. Wall panel: Prepainted galvanized corrugated steel sheet

Roof panel: Prepainted galvanized corrugated steel sheet

Door: Steel roller door



PROJECT OVERVIEW

STEEL STRUCTURE SMART MOTOR PRODUCTION BASE

Steel structure smart motor production base features of high fire resistance, strong corrosion resistance. Steel structure is mainly refers to the main bearing component is composed of steel. Including the steel columns, steel beam, steel structure, steel roof truss. Each component using welds, bolts or rivets to connect.



Industry: Smart motor production base	Place: USA	
Dimensions: 98x63x13.2m	Square Footage: 6,174sqm	
Column/Beam: H steel	Wall purlin: C purlin	Roof purlin: C purlin
Brace structure: Tie rod, tube, angel steel.	Wall panel: Prepainted galvanized corrugated steel sheet	
Roof panel: Prepainted galvanized corrugated steel sheet	Door: Steel roller door	





3000m² workshop

7000m² workshop



1000m² warehouse



4000m² workshop



12000m² workshop



PAGE 9
25000m² workshop

K HOUSE



K Type Modular House:

With the steel structure and sandwich panel structural composition, K-house always stand as a substantial building and widely use for construction site office and canteen, disaster victims camp...

Application:

1. Worker camp
2. Temporary office
3. School
4. Warehouse, canteen, Toilet
5. Apartment

Standard material	Specifications
Technical parameter	#8 C-steel, 1.8mm
Roof panel	0.326mm PPGI, 50mm EPS sandwich panel
Wall panel	0.326mm PPGI, 50mm EPS sandwich panel
Window	PVC sliding window
Door	50mm EPS sandwich panel door
Flooring(1st floor)	Plywood+PVC carpet

Technical	parameter
Size	K=1.82mP=0.95m
Floor load	150 kg/sqm
Roof load	50 kg/sqm
Wind resistant	10 grades (28/s)
Earthquake resistant	7-8 grades
Life span	10 years

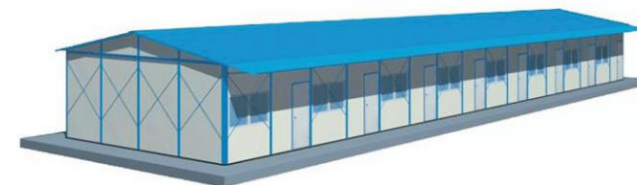

Building size:
4K*10K*3P (single floor)

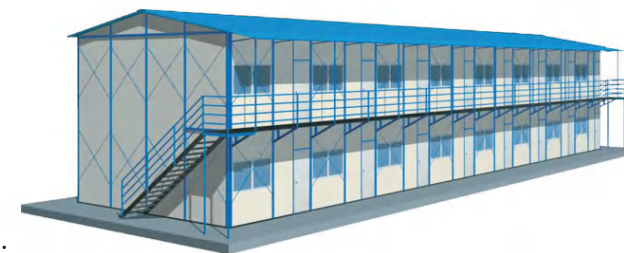

Building size:
4K*10K*6P (double floor)

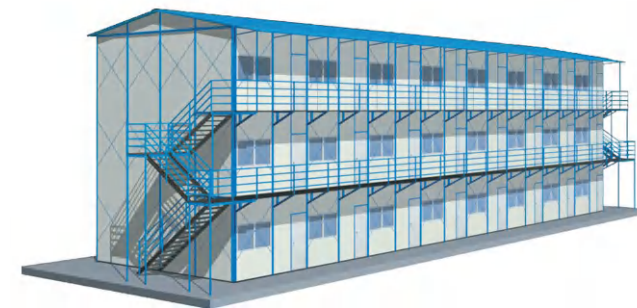

Building size:
4K*10K*9P (triple floor)

Width Length		One Floor(3P)			Two Floor(6P)			Three Floor(9P)		
		3K	4K	5K	3K	4K	5K	3K	4K	5K
4	K	45.53	59.07	72.61	103.79	130.87	157.95	176.84	217.46	258.08
5	K	56.67	73.52	90.38	126.97	160.68	194.39	212.07	262.63	313.19
6	K	67.81	87.98	108.14	150.16	190.49	230.82	247.31	37.81	368.3
7	K	78.95	102.43	125.9	173.35	220.3	267.26	282.54	352.98	423.41
8	K	90.09	116.88	143.67	196.53	250.11	303.69	317.78	398.15	478.52
9	K	101.22	131.33	161.43	219.72	279.93	340.13	353.01	443.32	533.63
10	K	112.36	145.78	179.19	242.91	309.74	376.57	388.25	488.5	588.74
11	K	123.5	160.23	196.96	266.09	339.55	413	423.48	533.67	643.85
12	K	134.64	174.68	214.72	289.28	369.36	449.44	458.72	578.84	698.96
13	K	145.78	189.13	232.48	312.47	399.17	485.88	493.96	624.01	754.07
14	K	156.92	203.58	250.25	335.65	428.98	522.31	529.19	669.18	809.18
15	K	168.06	218.03	268.01	358.84	458.79	558.75	564.43	714.36	864.29
16	K	179.19	232.48	285.77	382.03	488.61	595.19	599.66	759.53	919.4
17	K	190.33	246.93	303.54	405.21	518.42	631.62	634.9	804.7	974.51
18	K	201.47	261.38	321.3	428.4	548.23	668.06	670.13	849.87	1029.62
19	K	212.61	275.84	339.06	451.59	578.04	704.49	705.37	895.05	1084.73
20	K	223.75	290.29	356.83	474.77	607.85	740.93	740.6	940.22	1139.84
21	K	234.89	304.74	374.59	497.96	637.66	777.37	775.84	985.39	1194.95
22	K	246.02	319.19	392.35	521.15	667.48	813.08	811.07	1030.56	1250.06
23	K	257.16	333.64	410.12	544.33	697.29	850.24	846.31	1075.74	1305.17
24	K	268.3	348.09	427.88	567.52	727.1	886.68	881.54	1120.91	1360.28
25	K	279.44	362.54	445.64	590.71	756.91	923.11	916.78	1166.08	1415.38
26	K	290.58	376.99	463.4	613.9	786.72	959.55	952.01	1211.25	1470.49
27	K	301.72	391.44	481.17	637.08	816.53	995.99	987.25	1256.43	1525.6
28	K	312.85	405.89	498.93	660.27	846.35	1032.42	1022.48	1301.6	1580.71
29	K	323.99	420.34	516.69	683.46	876.16	1068.86	1057.72	1346.77	1635.82
30	K	335.13	434.79	534.46	706.64	905.97	1105.3	1092.95	1391.94	1690.93

T HOUSE



T Type Modular House:

T house is kind of a modular prefabricated house using light steel as the framework, sandwich panel as the containment system to combine a modularization dimension living or industrial house. With the quick install assemble, recycle use, environmental, high-efficiency advantage.

Standard material	
Steel structure	C-steel, square tube, I beam (1.8/2.0/2.5mm)
Roof panel	--0.326mm PPGI, 50mm EPS sandwich panel Density: 8kg --0.376mm PPGI, 50mm rock wool sandwich panel, density: 60kg
Wall panel	--0.326mm PPGI, 50mm EPS sandwich panel Density: 10kg --0.376mm PPGI, 50mm rock wool sandwich panel, density: 60kg
Window	--PVC sliding window --Alu. Sliding window
Door	--50mm EPS sandwich panel door --Wooden door --Alu. door
Flooring (1st /2nd/ floor)	--Plywood·PVC carpet --Cement board·vinyl --Galvanized steel plate·ceramic tile

Technical parameter	
Size	Width, Length: T=1.15m
	Height: H=1m
Floor load	150-250 kg/m ²
Roof load	50 kg/m ²
Wind resistant	10 grades (28/s)
Earthquake resistant	7-8 grades
Life span	15-20 years



Senior Accommodation

Building size:
7.7m*40.5m*6m

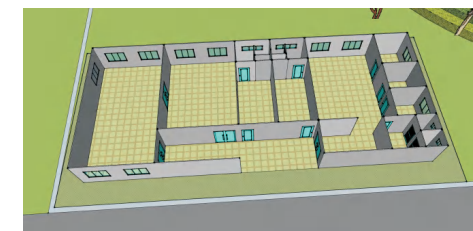

Office

Building size:
12m*29.7m*3m



Senior Accommodation

Building size:
12m*29.8m*6.6m



Worker Camp

Building size:
4.6m*14.95m*3m

K HOUSE Project Case



8500m² Worker Camp

T HOUSE Project Case



600m² Office



7085m² Employee dormitory



Customized T House

8875 Light Steel Structure Villa



Product code	VH8875	Size	8800*7500*3000mm
Layout	2 bedrooms, 1 bathroom, 1 open kitchen, 1 living room	Steel frame	Painted light steel
Wall	50mm Rock wool sandwich + PVC cladding	Roof	50mm Rock wool sandwich + resin roof
Floor	Fiber cementboard+wooden flooring	Window	Alu. sliding window, double layer tempered glass
Door	Alu. Sliding door	Ceiling	0.5mm alu. ceiling
Floor bear loading	250kg/m ²	Wind load	150km/h
Roof load	70kg/m ²	Life span	20 years

Living house

Living house is a upgrade prefabricated house based on the modular house, dimension is totally customized, more kinds of materials for options, design according to the customer's technical and living requirements. With the steel structure and the sandwich panels as the principle part, add some decoration materials, Living house can give more choices for the clients, to satisfy the different requirements of the different countries, different area, different appearance and different function.

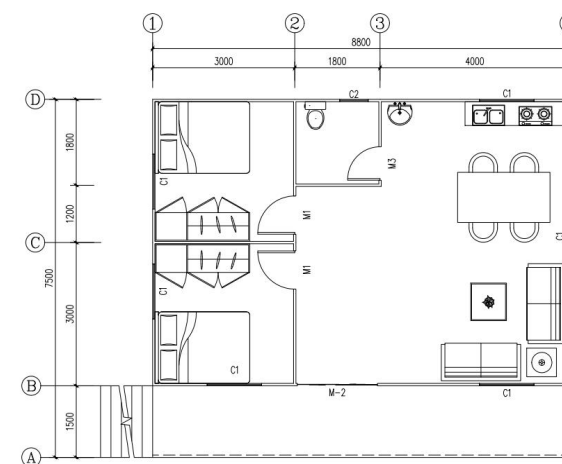

Project Case



House code: VH0810
Size: 8m*10m*3m



House code: VH0607
Size: 6m*7m*3m



House code: VH0506
Size: 5m*6m*3m



Quick Container Assembly

Portable house

The portable house is a new style of the temporary prefabricated house, with its low cost, easy assembly and functional usage, it becomes a very popular movable house all over the world. Totally knock down package, reduce the shipping cost; flexible design, give more choices for the clients and the beautiful living condition; different spatial distribution, give you a flexible space utilization.

Advantage:

- Reliable structure
- Easy & quick assemble and disassemble
- Customized design
- Long life span
- Recycle use

Application:

- Holiday house
- Resort cabin
- Office
- Retail store



House code	BF-PH-0603
Size	L5950*W6000*H5600mm
Area	35.7sqm*2
Weight	1280kg
Roof Live Load	30kg/m ²
Floor Bear Load	200kg/m ²
Available stack-up	Single layer/double layer
Assemble time	2 workers in 4 hours
Standard Material	Wall: 50mm EPS sandwich panel Roof: 50mm EPS sandwich panel Painted steel chassis Window: Aluminum sliding window Door: 50mm sandwich panel door/Steel door Floor: 18mm plywood+1mm PVC carpet



Portable house

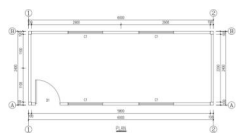

House Code : PH0624
House Size : 6m*2.4m*2.6m

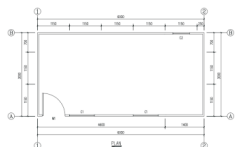

House Code : PH0603
House Size : 6m*3m*2.6m

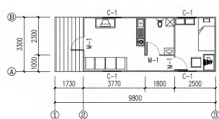

House Code : PH9833
House Size : 9.8m*3.3m*2.6m

House Code : PH10433
House Size : 10.4m*3.3m*2.6m

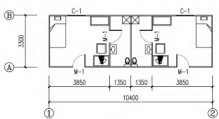

House Code : PH10433

House Code : PH1230
House Size : 12m*3m*2.6m

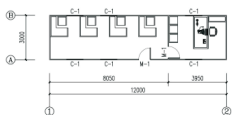

House Code : PH14433
House Size : 14.4m*3.3m*2.6m

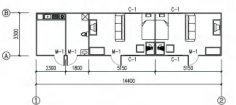

House Code : PH9833



House Code : PH0202



House Code : PH02250

Sandwich panel for wall



Product Code: SW-EPS-1150
 Product Name:EPS sandwich panel
 Fire resistance: /
 Application: projects with no requirement on fireproof

Density	8/10/12/14/20 kg/m ³
Thickness	50/75/100/150mm
Effective width	950/1150mm
Thickness of the color steel sheet	0. 3/0. 35/0. 4/0. 45/0. 5mm
Color of the color steel sheet	gray white/skyblue/lotus leaf green/brightred/silvery gray



Product Code: SW-RW-1150
 Product Name:Rock wool sandwich panel
 Fire resistance: 60 mins
 Application: Projects requires fireproof performance

Density	60/80/100/120 kg/m ³
Thickness	50/75/100/150mm
Effective width	950/1150mm
Thickness of the color steel sheet	0. 3/0. 35/0. 4/0. 45/0. 5mm
Color of the color steel sheet	gray white/skyblue/lotus leaf green/brightred/silvery gray



Product Code: SW-PU-1150
 Product Name:PU(Poly Urethane) sandwich panel
 Application: projects requires excellent heat insulation performance, like cold room

Density	35/38 kg/m ³
Thickness	50/75/100/150mm
Effective width	950/1150mm
Thickness of the color steel sheet	0. 3/0. 35/0. 4/0. 45/0. 5mm
Color of the color steel sheet	gray white/skyblue/lotus leaf green/brightred/silvery gray



Product Code: SW-MgO-1150
 Product Name:MGO(magnesium) sandwich panel
 Fire resistance: 90 mins
 Application: Hospital, Electronic workshop, Medical production line.

Thickness	50/75/100/150mm
Effective width	950/1150mm
Thickness of the color steel sheet	0. 35/0. 4/0. 45/0. 5mm
Color of the color steel sheet	gray white/skyblue/lotus leaf green/brightred/silvery gray

Sandwich panel for roof

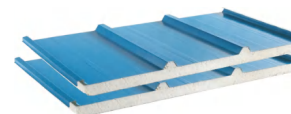

Product Code: SW-EPS-1050
 Product Name:EPS sandwich panel
 Application: Most Widely used.

Density	8/10/12/14/20 kg/m ³
Thickness	50/75/100mm
Effective width	950/1150mm
Thickness of the color steel sheet	0. 3/0. 35/0. 4/0. 45/0. 5mm
Color of the color steel sheet	gray white/skyblue/lotus leaf green/brightred/silvery gray



Product Code: SW-RW-960
 Product Name:Rock Wool sandwich panel
 Applied in the project requires fireproof

Density	60/80/100/120 kg/m ³
Thickness	50/75/100/150mm
Effective width	960mm
Thickness of the color steel sheet	0. 3/0. 35/0. 4/0. 45/0. 5mm
Color of the color steel sheet	gray white/skyblue/lotus leaf green/brightred/silvery gray

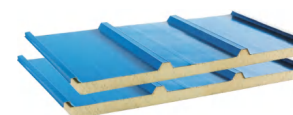

Product Code: SW-PU-1050
 Product Name: PU sandwich panel
 Application: Project requires excellent heat insulation performance and strong bear load

Density	35/38 kg/m ³
Thickness	50/75/100/150mm
Effective width	960/1050mm
Thickness of the color steel sheet	0. 3/0. 35/0. 4/0. 45/0. 5mm
Color of the color steel sheet	gray white/skyblue/lotus leaf green /brightred/silvery gray

Quality control

The quality is controlling under a Qc team, their work begins from the prder effective.From the purchasing and ware housing, semi-finished products, to the finished products, each step we have our QC team to follow up, to make sure the qualityis 100% correctly.



Package

Considering about the materials can be easy damaged during delivery,unloading , and storage. We enhance the protective package to the materials and provide customers two manual "Guide of unloading "&"Guide of Storage" to confirm all the material delivery on site with 100% good condition



Loading

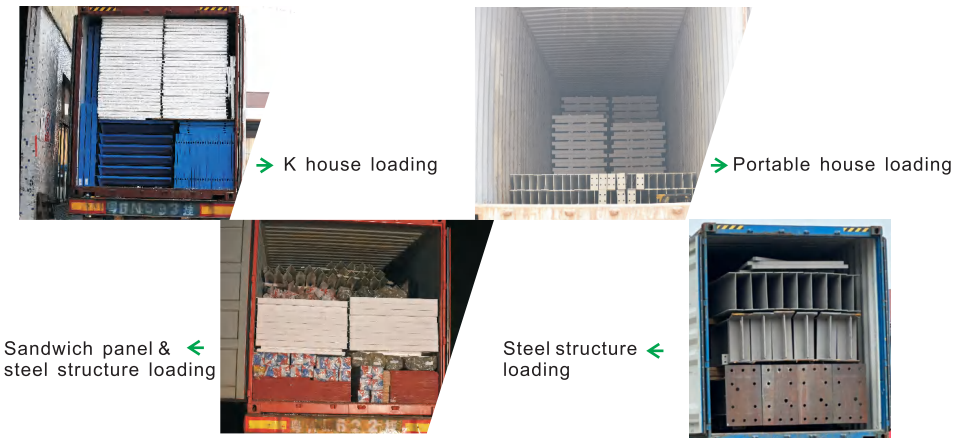

Outstanding R&D Team

“Our R&D Team keeps improving the existing products and develop one new product each year. Our Technical Team skillful use "Adobe Photo Shop CS6", "Auto CAD 2005", Lumion 5.0", "SketchUp 2015", Tekla Structures 16.0" & "3D" etc. softwares.

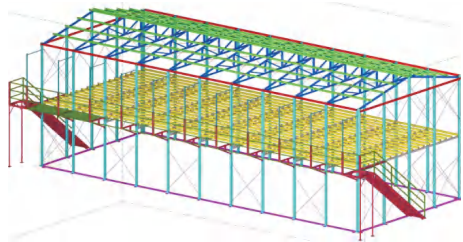
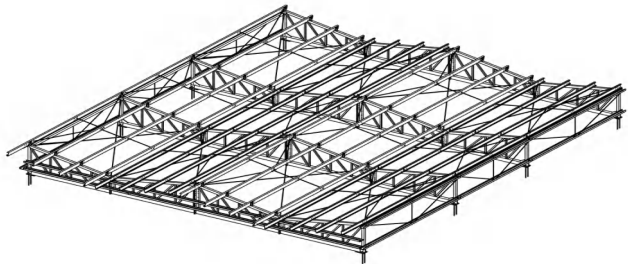

Bingfa Service



“As a good partner, Bingfa will always support our valued customers to be more successful and always provide the below service.

- ◆ Supervisor on site to instruct assembling.
- ◆ Train your staffs
- ◆ Provide our assemble team
- ◆ Provide professional Guidance to assemble

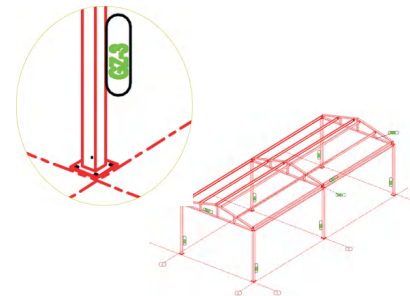

The detailed assemble drawing & video will provide for the better understand of the assemble



Project: Uruguay Family Housing Job No.: 3PH 001
Spec.: 5'12"3m Area: 60m2

No.	Component Code	Spec.	L/mm	Unit	Qty.	IT
3	GZ-2	SHS 100*100	2904	pcs	2	Q235/messe green
3	GZ-2	SHS 100*100	2904	pcs	2	Q235/messe green
3	GZ-3	SHS 100*100	2964	pcs	2	Q235/messe green

All the components are labeling before loading



Engineering project



Yunfu Hydropower No.6 Bureau



Aopu Aluminium Industry Co., LTD



Meilin Construction Site



Meilin Construction Site's interior view



Zhaoqing Hengfan Chemical Co., Ltd



Foshidi Warehouse&workshop

exhibition



Huigu Construction Site



Chaolang Workshop



Meilin Construction Site's staircase



Zhongchenghui Industrial Co., LTD



Dawang Construction Site



Villa in Malaysia